



## **HAZARDOUS MATERIALS ASSESSMENT**

### **Prince County Forestry Depot**

**40 Hackmatack Rd,  
Wellington Station, PE**

**Prepared For:**

**PEI Department of Transportation & Infrastructure  
P.O. Box 2000  
Charlottetown, PE**

**April 1, 2023**

**ALL-TECH Project No.: PE22400**



**ALL-TECH Environmental Services Limited, 70 Nicholas, Unit 4, Charlottetown, PE, C1E 3J5**  
**Phone: (902) 569-0172 Web: <http://www.toalltech.com>**

**Bedford, NS Sydney, NS St. John, NB Moncton, NB Charlottetown, PE St John's, NL Cornerbrook, NL Gander, NL**

## EXECUTIVE SUMMARY

*ALL-TECH Environmental Services Limited* was contracted by the PEI Department of Transportation & Infrastructure (DTI) to conduct a hazardous material assessment for the Prince County Forestry Depot located at 40 Hackmatack Road in Wellington Station, Prince Edward Island.

The purpose of the assessment was to identify hazardous materials within the building which may require safe handling procedures and disposal requirements in accordance with their applicable regulations prior to any planned work, renovations, or demolition and to assist in the Asbestos Management Plan (AMP) of any in place asbestos containing materials (ACM).

This report has been prepared to document the identities, usages and locations of any designated substances and hazardous materials identified within the building.

The on-site assessment was conducted in December 2022. During the assessment hazardous materials including asbestos and lead (paint) were sampled. In addition, lamp ballasts and electrical transformers were visually assessed for Polychlorinated Biphenyls (PCBs) and reported if identified.

Based on the findings from the Hazardous Materials Assessment, the following conclusions and recommendations are presented:

A summary of the Hazardous Materials identified within the building is provided below in Table A based on our assessment as well as safe handling requirements.

Assessment Summary of ACM conditions and action report is outlined in Appendix IV and shall be used in conjunction with PEI Department of Transportation & Infrastructure's Asbestos Management Plan (2023) and shall be subject to annual review.

Other hazardous materials identified through sampling or visual assessment are noted in section 4 and are summarized in Appendix V.

Upon review of this report and based on any planned work, renovations or demolition, a full scope of work should be developed. This scope of work will be dependent upon which materials need to be disturbed or removed prior to the renovations. Should ACM not require disturbance or removal, then those identified shall remain in place and be part of the Management Plan.

| <b>TABLE A</b><br><b>Summary of Hazardous Materials for Management Plan</b><br><b>Prince County Forestry Depot</b> |   |   |   |
|--|---|---|---|
| <b>Hazardous Materials</b>   | <b>Description / Comments</b>   | <b>Safe Handling Requirements</b>   | <b>Disposal Requirements</b>  |
| <b>ASBESTOS</b>  | Tan vinyl sheet flooring /<br>Garage Bathroom   | Licensed contractor to obtain work permit prior to handling from PEI Dept. of WCB/OSH Division and all other pertinent sections of the <i>Occupational Health and Safety Act R.S.P.E.I.</i> | Regulatory approval from PEIELJ<br><br>Disposal at approved facility such as EPWMF in Wellington, PEI   |
| <b>SILICA</b>  | Presumed in the following building components:<br><ul style="list-style-type: none"> <li>• Poured or pre-cast concrete (building basement; Garage floor)</li> </ul> | Trained personnel in the safe handling of silica dust and all other pertinent sections of the <i>Occupational Health and Safety Act R.S.P.E.I.</i>  | Regulatory approval from PEIELJ   |
| <b>MERCURY</b>   | fluorescent lamp tubes; thermostats   | Do not break lamps or separate liquid mercury from components   | Recycle and reclaim mercury from fluorescent lamps and thermostats when taken out of service. Mercury is classified as a hazardous waste and must be disposed of in accordance with applicable Regulations. |

**This summary should not be used alone. The report must be read in its entirety.**



**Larry Koughan, CET, CRSP**  
**Project Principal**  
**ALL-TECH Environmental Services Limited**

## Table of Contents

|   |    |
|---|----|
| SITE / CLIENT INFORMATION .....             | 1  |
| 1 INTRODUCTION.....                         | 1  |
| 1.1 SURVEY OBJECTIVES.....                  | 1  |
| 1.2 BACKGROUND BUILDING INFORMATION .....   | 2  |
| 2 REGULATIONS & GUIDELINES .....            | 2  |
| 2.1 ASBESTOS .....                          | 3  |
| 2.2 LEAD .....                              | 3  |
| 2.3 POLYCHLORINATED BIPHENYLS (PCB's) ..... | 4  |
| 3 METHODOLOGY .....                         | 5  |
| 3.1 ASBESTOS .....                          | 5  |
| 3.2 LEAD .....                              | 5  |
| 3.3 POLYCHLORINATED BIPHENYLS .....         | 5  |
| 4 ASSESSMENT FINDINGS .....                 | 6  |
| 4.1 ASBESTOS .....                          | 6  |
| 4.1.1 Texture Coat Finishes .....           | 6  |
| 4.1.2 Pipe Insulation .....                 | 6  |
| 4.1.3 Duct Insulation .....                 | 7  |
| 4.1.4 Mechanical Equipment Insulation ..... | 7  |
| 4.1.5 Plaster.....                          | 7  |
| 4.1.6 Drywall Joint Compound .....          | 7  |
| 4.1.7 Vinyl Sheet Flooring.....             | 8  |
| 4.1.8 Vinyl Floor Tiles.....                | 8  |
| 4.1.9 Ceiling Tiles.....                    | 8  |
| 4.1.10 Excluded Asbestos Materials.....     | 9  |
| 4.2 LEAD-BASED PAINTS.....                  | 9  |
| 4.3 POLYCHLORINATED BIPHENYLS (PCB's) ..... | 11 |
| 4.3.1 Lighting Lamp Ballasts .....          | 12 |
| 4.3.2 Transformers .....                    | 12 |
| 4.4 SILICA.....                             | 12 |
| 4.6 MERCURY .....                           | 12 |
| 4.6.1 Lighting.....                         | 12 |
| 4.6.2 Mercury Containing Devices .....      | 13 |
| 5 SUMMARY OF HAZARDOUS MATERIALS.....       | 13 |

|     |  |    |
|-----|--|----|
| 6   | ON-GOING MANAGEMENT & MAINTENANCE..... | 14 |
| 6.1 | Asbestos.....                          | 14 |
| 6.2 | PCBs.....                              | 14 |
| 6.3 | Silica .....                           | 15 |
| 6.4 | Mercury.....                           | 15 |
| 7   | DISCLAIMER.....                        | 15 |

|              |   |
|--------------|---|
| Appendix I   | Laboratory Certificate of Analysis – Asbestos PLM Samples |
| Appendix II  | Laboratory Certificate of Analysis – Lead Paint Samples   |
| Appendix III | Site Drawings with sample locations                       |
| Appendix IV  | Summary of ACM conditions report                          |
| Appendix V   | Summary of other Hazardous Materials report               |

## SITE / CLIENT INFORMATION

|                  |  |
|------------------|--|
| Project No:      | PE22400  |
| Assessment Date: | December 2022  |
| Client Name:     | PEI Department of Transportation & Infrastructure                            |
| Address:         | Prince County Forestry Depot<br>40 Hackmatack Road<br>Wellington Station, PE |

## 1 INTRODUCTION

*ALL-TECH Environmental Services Limited* was contracted by the PEI Department of Transportation & Infrastructure (DTI) to conduct a hazardous material assessment for the Prince County Forestry Depot located at 40 Hackmatack Road in Wellington Station, Prince Edward Island.

The purpose of the assessment was to identify hazardous materials within the building which may require safe handling procedures and disposal requirements in accordance with their applicable regulations prior to any planned work, renovations, or demolition and to assist in the Asbestos Management Plan (AMP) of any in place asbestos containing materials (ACM).

This report has been prepared to document the identities, usages and locations of any designated substances and hazardous materials identified within the building.

The on-site assessment was conducted in December 2022. During the assessment hazardous materials including asbestos and lead (paint) were sampled. In addition, lamp ballasts and electrical transformers were visually assessed for Polychlorinated Biphenyls (PCBs) and reported if identified.

### 1.1 SURVEY OBJECTIVES

The scope of the survey was to conduct a non-destructive assessment to identify asbestos, lead, and PCBs within the subject building as well as any other suspect hazardous materials if encountered. ALL-TECH inspected both interior and exterior spaces of the subject building to determine whether designated substances and hazardous materials were present. Representative sampling for suspect asbestos and lead paint materials was conducted as required based on industry standards and the consultant's experience.

## 1.2 BACKGROUND BUILDING INFORMATION

| TABLE 1<br>BUILDING FRAMEWORK |   |
|-------------------------------|---|
| Building Use                  | Forestry offices / Garage   |
| Number of Floors              | 2 floors plus garage  |
| Total Area                    | Office Building - Approximately 242 m <sup>2</sup><br>Garage - Approximately 147 m <sup>2</sup> |
| Year of Construction          | 1978  |
| Structure                     | Wood, concrete  |
| Exterior Cladding             | Wood  |
| HVAC                          | NA  |
| Roof                          | Metal   |
| Flooring                      | Office Building - Vinyl sheet flooring; vinyl floor tiles<br>Garage - concrete                  |
| Interior Walls                | Office Building – Drywall<br>Garage - Wood  |
| Ceilings                      | Office Building – Acoustic ceiling tiles; drywall<br>Garage – Wood; acoustic ceiling tiles      |

## 2 REGULATIONS & GUIDELINES

A summary table (Table 2) is provided for the applicable regulations, policies, codes, and / or guidelines of hazardous materials assessed for the purpose of this report. This information was used as reference to assess suspect hazardous materials and make recommendations based on the findings.

| TABLE 2<br>SUMMARY OF REGULATORY FRAMEWORK |   |
|--|---|
| <b>ASBESTOS</b>                            | <ul style="list-style-type: none"> <li>▪ <i>Occupational Health and Safety Act</i> R.S.P.E.I. 1988, Cap. O-1.01 General Regulations – Part 49 (Including any amendments to May 2021).</li> <li>▪ Guide to Asbestos Management, Workers Compensation Board of PEI.</li> <li>▪ <i>Environmental Protection Act Chapter E-9 Waste Management Regulations</i>, Prince Edward Island</li> <li>▪ Transportation of Dangerous Goods Act (TDGA)</li> </ul>                |
| <b>LEAD</b>                                | <ul style="list-style-type: none"> <li>▪ Hazardous Products Act</li> <li>▪ Prince Edward Island Department of Environment, Labour and Justice (PEIELJ)</li> <li>▪ Transportation of Dangerous Goods Act (TDGA)</li> <li>▪ The Environmental Abatement Council of Canada (EACC) Lead Guideline for Construction, Renovation, Maintenance or Repair.</li> <li>▪ Surface Coating Materials Regulations, SOR/2016-193, Canada Consumer Product Safety Act.</li> </ul> |

- Environmental Contaminants Act, Chlorophenyl Regulations
- Environment Canada – "Identification of Lamp Ballasts Containing PCB's," report EPS 2/CC/2 (revised) August 1991
- PCB Regulations, SOR/2008-273, Canadian Environmental Protection Act.

## 2.1 ASBESTOS

Asbestos materials can be found in one of two forms: friable asbestos or a non-friable type. Friable asbestos material refers to material that when dry, can be crumbled, pulverized, or reduced to a powder by hand pressure. This type of asbestos material is hazardous due to its potential to become airborne, if damaged or disturbed.

Friable asbestos building products used that have been used in the past are sprayed acoustic and fire protection insulation which were installed on mechanical room ceilings, building structures, ceiling finishes, etc., and mechanical insulation on piping, tanks, boilers, vessels, etc. Some non-friable building products are vinyl acoustic floor tiles, gaskets, transite panels, piping, and shingles.

Non-friable materials if handled improperly during removal or renovations, such as cutting transite panels with an electrical tool, can cause high fiber releases.

Asbestos is classified as a hazardous material under the TDGA and must adhere to specific requirements for transfer including but not limited to waste transfer manifests and proper placards. All asbestos waste must be disposed of at an approved municipal solid waste disposal site. Recent changes from the Prince Edward Island's Department of Environment's Environmental Protection Act, Waste Resource Management Regulations have defined asbestos as "special waste" as asbestos containing materials containing 1% or greater by weight for the purpose of disposal.

All work should be carried out by personnel trained and licensed with the provincial department of the Workers Compensation Board / Occupational Health and Safety Division for asbestos abatement.

## 2.2 LEAD

Lead in paints is regulated under the Canadian Environmental Protection Act (CEPA) as published in Canada Gazette Part II. The lead content limit has been set to 600 mg/kg (0.06 percent by weight) for surface coating materials.

Any disturbance or removal of lead-based materials which may generate lead dust shall have to conform to the federal and provincial Occupational Health and Safety Act and Regulations. All work should be carried out by personnel trained in the safe handling of lead-based paint coatings and shall be trained in the use of respirators and be properly fit tested.

PEIELJ has established guidelines that restrict hazardous materials from municipal landfills and Construction and Demolition (C&D) waste disposal sites which potentially may migrate / leach into groundwater and cause adverse environmental impacts. Lead coated surfaces may leach from their base materials into soil and subsequent groundwater. PEIELJ has established guidelines that materials containing 1000 mg/kg or 0.1% lead by weight shall be classified as lead-based paints. If materials are found to be above this guideline and require removal and disposal, then the materials must undergo leachate testing to assess total concentrations which could potentially leach into the ground soil and groundwater. Presently provincial requirements for lead leachate testing shall not exceed 5 mg/L. Disposal criteria for lead containing paints are based on total and leachable concentrations are as follows:

- Materials with total lead concentrations below the applicable Total guidelines can be disposed of at any C&D disposal site.
- Materials with *total lead concentrations above* the applicable Total guidelines and *leachable lead concentrations below* the applicable Leachate guidelines must be disposed of at an approved municipal solid waste landfill that has a composite liner and leachate collection system (i.e., East Prince Waste Management Facility in Wellington, PEI). A waste generator permit must first be approved and obtained by PEIELJ.
- Materials with total and leachable lead concentrations above provincial guidelines must be transported to an approved hazardous waste disposal site.

Materials with leachable lead concentrations above provincial guidelines must be manifested as dangerous goods during transport under the federal TDGA. Hazardous materials that are being disposed of out of province must comply with Interprovincial Movement of Hazardous Waste Regulations under the Canadian Environmental Protection Act (CEPA).

## 2.3 POLYCHLORINATED BIPHENYLS (PCB's)

In 1976, the Canadian Environment Contaminants Act passed regulations which prohibited the use of PCBs in transformer equipment. Under the same Act, the Chlorophenyl Regulations No. 1, states that PCBs cannot be used as a constituent of electrical capacitors, electrical transformers and associated electrical equipment manufactured in or imported into Canada after July 1, 1980.

There is currently no regulatory requirement to remove in-use PCBs from service. However, should suspect PCB containing light ballasts be removed from service, they should be treated as PCB waste or if confirmed to contain PCB oil in excess of 0.5 kg.

## 3 METHODOLOGY

The scope of work for the survey was to visually identify controlled hazardous materials for the safe handling and disposal of hazardous materials prior to renovations within the building. Where visual identification of asbestos containing materials and lead based paints were suspected but unable to be determined, samples were collected and sent to an approved laboratory for analysis.

There was limited destructive testing of structural members (i.e., walls, flooring) during the assessment. Where accessible, areas above ceiling cavities and behind walls were visually assessed to identify potentially concealed hazardous materials.

### 3.1 ASBESTOS

Using standard bulk sampling methodologies, representative suspect asbestos containing materials were sampled from ceiling & wall finishes, floor coverings, located throughout the building. Samples were placed in sealed plastic bags, labelled and a chain of custody form completed to be forwarded to IATL Laboratory via courier for analysis.

The asbestos assessment involved a visual investigation of suspect materials for the presence of asbestos containing materials. If these materials were suspected to contain asbestos, a bulk sample was collected of the representative material to be analysed with Polarized Light Microscopy.

It should be noted that asbestos containing materials may be present behind unrevealed areas. During demolition of these materials, precautions should be taken such as the use of personal protective equipment in the event of exposing concealed asbestos materials. If suspect materials are revealed, have them tested immediately.

### 3.2 LEAD

During the assessment, suspect lead-based paints were sampled from surfaces as determined by the consultant. Where practical, all layers of paint were removed and placed in sealed plastic bags, labelled and a chain of custody form completed to be forwarded to IATL Laboratory via courier for analysis.

### 3.3 POLYCHLORINATED BIPHENYLS

During the assessment, suspect PCB containing light ballasts were examined for PCB identification or by recording serial numbers for reference. Ballasts were inspected and manufacturers name, date and serial numbers were recorded when visible. The manufacturers identification numbers were then

compared to Environment Canada's "Identification of Lamp Ballasts Containing PCB's," Report EPS 2/CC/2 9revised), August 1991.

It should be noted that the assessment did not include the sampling / testing or analysis of the suspect PCB containing materials.

## 4 ASSESSMENT FINDINGS

### 4.1 ASBESTOS

During the survey, the consultant collected individual bulk material samples of suspect ACMs within the structure. Laboratory analysis certificates are presented in Appendix I.

A total of twenty-two (22) bulk material samples were collected within the buildings during the survey. Of the 22 samples analyzed, one (1) was found to be asbestos containing. Some of these samples such as tile floor coverings were separated and a total of twenty-three (23) samples were analyzed. Of the 23 samples analyzed, one (1) was found to be asbestos containing.

Other materials such as pipe and duct insulations visually identified as fiberglass insulation were noted and not sampled.

For details on approximate quantities, condition, friability, accessibility and locations of hazardous materials; refer to the Summary of ACM conditions report in Appendix IV.

Individual items sampled and ACM materials identified are itemized in each sub-section below.

#### 4.1.1 Texture Coat Finishes

|   |  |
|---|--|
| Texture coat finishes were not observed or reported |  |
|---|--|

#### 4.1.2 Pipe Insulation

|   |  |
|---|--|
| Office Building / Garage - straight sections as well as pipe fittings insulated with fiberglass insulation. |  |
|---|--|

#### 4.1.3 Duct Insulation

No insulated ducts were observed or reported.



#### 4.1.4 Mechanical Equipment Insulation

No mechanical equipment insulations were observed or reported.



Office Building boiler system



Garage furnace system

#### 4.1.5 Plaster

No plaster finishes were observed or reported within the office building or garage.

#### 4.1.6 Drywall Joint Compound

Drywall joint compound walls and ceilings were noted and sampled in various random locations throughout the building.

Representative sampling was completed on each floor of the building.

A total of six (6) joint compound samples were collected within the office building and three (3) joint compound samples collected within the garage during the assessment. None of the samples were found to contain asbestos.

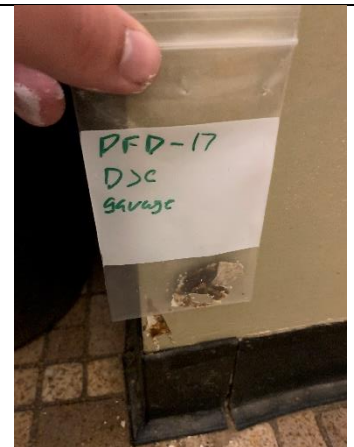
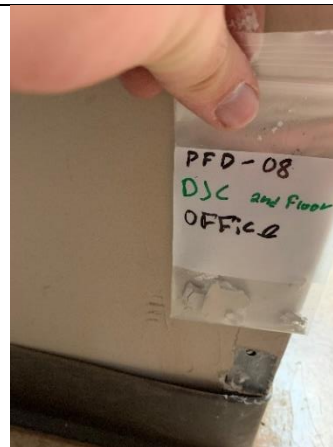

#### 4.1.7 Vinyl Sheet Flooring

| Sample No.:                | Flooring Description               | Location                 | Asbestos Type / Content (%) | Photo  |
|----------------------------|------------------------------------|--------------------------|-----------------------------|--|
| PED-10<br>PED-11<br>PED-12 | Tan vinyl sheet flooring           | Main floor various areas | None Detected               |   |
| PED-19                     | Brown and tan vinyl sheet flooring | Garage washroom          | 20% Chrysotile              |  |

#### 4.1.8 Vinyl Floor Tiles

No vinyl floor tiles were observed in the assessed areas.

#### 4.1.9 Ceiling Tiles

In-lay acoustic fissure ceiling tiles were observed and sampled in various random locations throughout the office and garage buildings. The ceiling tiles were observed as like materials throughout.

A total of six (6) fissure design ceiling tiles samples were collected within the office building and three samples collected within the garage during the assessment. None of the samples were found to contain asbestos.

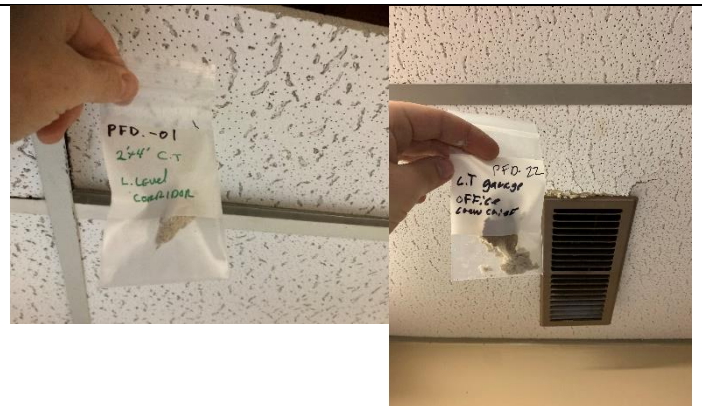

#### 4.1.10 Excluded Asbestos Materials

The following is a list of materials which may contain asbestos and were excluded from the assessment. These materials are presumed to contain asbestos until otherwise proven by sampling and analysis:

- Roofing felts and tar



## 4.2 LEAD-BASED PAINTS

Based on the age of the buildings, lead based paints were sampled. A total of ten (10) painted surface coatings were sampled within the buildings and sent to the laboratory for analysis for lead in paint.

Based on the assessment findings, none of the paint layers sampled exceeded CEPA guidelines of 0.06 percent by weight for surface coating materials.

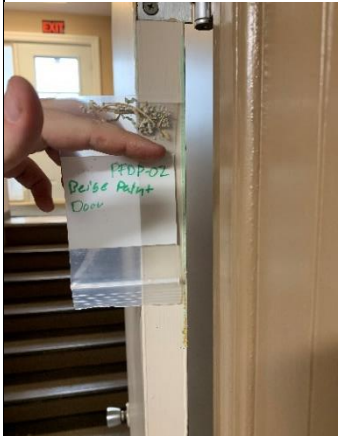
Laboratory analysis certificate is presented in Appendix II.

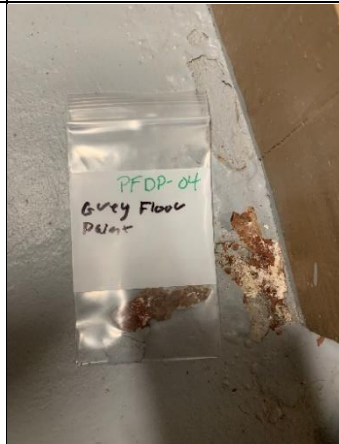
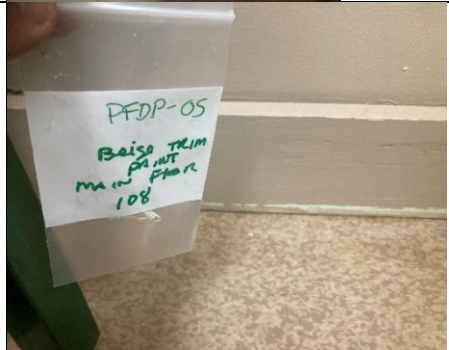
| Sample No.:     | Colour / Substrate Description | Location    | Lead Content (%) | Photo   |
|-----------------|--------------------------------|-------------|------------------|---|
| Office Building |                                |             |                  |   |
| PFDP-01         | Brown paint / Wood trim        | Lower level | < 0.0072         |   |
| PFDP-02         | Beige paint / Wood trim        | Lower level | <0.0056          |  |

|         |                              |                     |          |   |
|---------|------------------------------|---------------------|----------|---|
| PFDP-03 | Green paint / Drywall        | Lower-level office  | 0.021    | NA  |
| PFDP-04 | Grey paint / Cement flooring | Boiler room         | < 0.0069 |    |
| PFDP-05 | Beige paint / Door trim      | Main floor room 108 | <0.017   |   |
| PFDP-06 | Grey paint / Wood siding     | Exterior            | <0.0087  |  |
| PFDP-07 | White paint / Wood door trim | Exterior            | 0.035    | NA  |

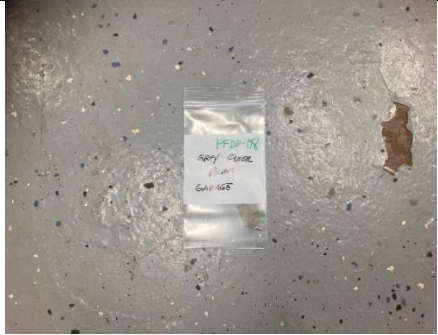
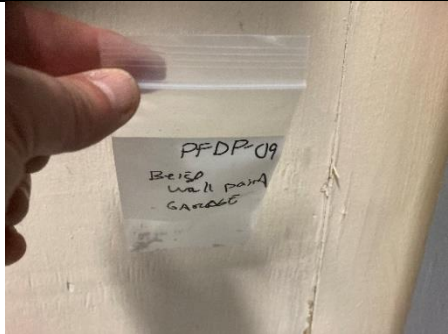
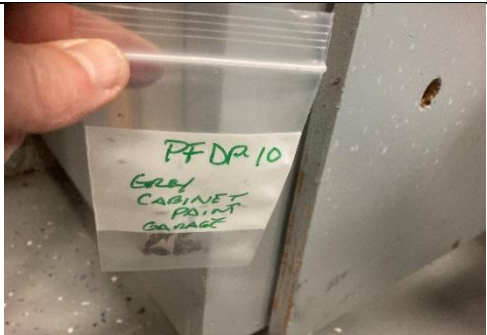
| Garage  |                              |        |          |  |
|---------|------------------------------|--------|----------|--|
| PFDP-08 | Grey paint /<br>Floor        | Garage | <0.0075  |   |
| PFDP-09 | Beige paint /<br>Wood siding | Garage | <0.0068  |   |
| PFDP-10 | Grey paint /<br>Wood cabinet | Garage | < 0.0068 |  |

### 4.3 POLYCHLORINATED BIPHENYLS (PCB's)

In-lay and recessed light fixtures were observed within the buildings. Some light fixtures were also noted with no ballasts. Typical ballasts found and reported are noted below in section 4.3.1.

Some replaced ballasts were marked on manufacturers' labels as Non-PCB containing. Other original ballasts are still present and through referencing were determined that these ballasts are considered PCB containing.

### 4.3.1 Lighting Lamp Ballasts

Photo 1 – SOLA Basic Limited Fluorescent Lamp Ballasts – Serial No.: 570-302T. Through referencing, these ballasts are considered **PCB containing**.

Photo 2 – Typical recessed light fixtures for these ballasts.

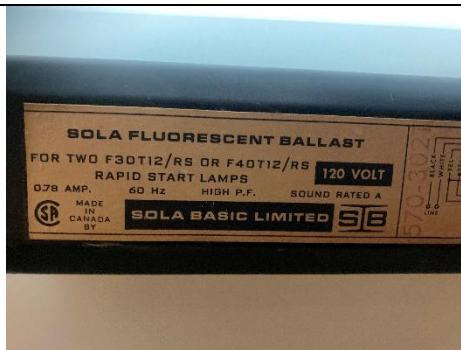

Photo 1



Photo 2

Photo 3 – Philips Lamp Ballasts – Serial No.: 72266 Ballast marked as No PCB's.

Photo 4 – Typical in-lay light fixtures for these ballasts.

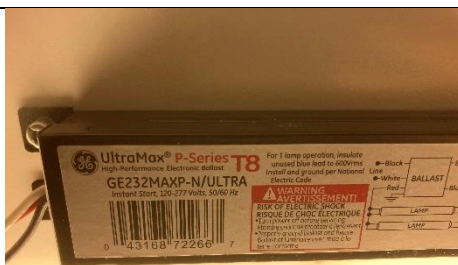

Photo 1



Photo 2

### 4.3.2 Transformers

Electrical transformers were not found or reported during the assessment.

## 4.4 SILICA

Crystalline silica is a presumed component of the following materials:

- Poured or pre-cast concrete (building basement / garage floor)

## 4.6 MERCURY

### 4.6.1 Lighting

Mercury vapour is present in fluorescent lamp tubes.

#### 4.6.2 Mercury Containing Devices

Mercury containing thermostats were observed within the building on the lower and upper floors.



## 5 SUMMARY OF HAZARDOUS MATERIALS

A summary of the Hazardous Materials identified within the building is provided below in Table 3 based on our assessment as well as safe handling requirements.

Assessment Summary of ACM conditions and action report is outlined in Appendix IV and shall be used in conjunction with PEI Department of Transportation & Infrastructure's Asbestos Management Plan (2023) and shall be subject to annual review.

Other hazardous materials identified through sampling or visual assessment are noted in section 4 and are summarized in Appendix V.

Upon review of this report and based on any planned work, renovations or demolition, a full scope of work should be developed. This scope of work will be dependent upon which materials need to be disturbed or removed prior to the renovations. Should ACM not require disturbance or removal, then those identified shall remain in place and be part of the Management Plan.

**TABLE 3**  
**Summary of Hazardous Materials for Management Plan**  
**Prince County Forestry Depot**

| <i>Hazardous Materials</i> | <i>Description / Comments</i>                  | <i>Safe Handling Requirements</i>   | <i>Disposal Requirements</i>  |
|----------------------------|--|---|---|
| <b>ASBESTOS</b>            | Tan vinyl sheet flooring /<br>Garage Bathroom  | Licensed contractor to obtain work permit prior to handling from PEI Dept. of WCB/OSH Division and all other pertinent sections of the <i>Occupational Health and Safety Act</i> R.S.P.E.I. | Regulatory approval from PEIELJ<br><br>Disposal at approved facility such as EPWMF in Wellington, PEI |
| <b>SILICA</b>              | Presumed in the following building components: | Trained personnel in the safe handling of silica dust and all other pertinent sections of the   | Regulatory approval from PEIELJ   |

|                |   |   |   |
|----------------|---|---|---|
|                | <ul style="list-style-type: none"> <li>Poured or pre-cast concrete (building basement; Garage floor)</li> </ul> | <i>Occupational Health and Safety Act R.S.P.E.I</i>           |   |
| <b>MERCURY</b> | fluorescent lamp tubes; thermostats   | Do not break lamps or separate liquid mercury from components | Recycle and reclaim mercury from fluorescent lamps and thermostats when taken out of service. Mercury is classified as a hazardous waste and must be disposed of in accordance with applicable Regulations. |

## 6 ON-GOING MANAGEMENT & MAINTENANCE

The following recommendations are made regarding on-going management and maintenance work involving the hazardous materials identified.

Perform a detailed intrusive assessment prior to building renovation or demolition operations. The assessment should include; destructive testing (e.g., coring and/or removal of building finishes and components), and other materials not previously tested (e.g., roofing materials, caulking, mastics).

### 6.1 Asbestos

Ensure policies and procedures outlined in the buildings Asbestos Management Plan (AMP) are followed when conducting asbestos-related work at this facility.

Perform a re-assessment of asbestos-containing materials (ACM) on an annual basis. The next reassessment of ACM should be performed prior to April 2024 to remain in compliance.

Remove ACM prior to alteration or maintenance work if ACM may be disturbed by the work. Follow appropriate asbestos precautions for the classification of work being performed.

Asbestos-containing materials must be disposed of at a landfill approved to accept asbestos waste.

### 6.2 PCBs

When light fixtures are removed from service, examine light ballasts for PCB content. If ballasts are not clearly labelled as “non-PCB,” or are confirmed or suspected to contain PCBs, package and ship ballasts for destruction at a federally permitted facility.

## 6.3 Silica

Disturbance of silica-containing products during maintenance activities may result in excessive exposures to airborne silica, especially if performed indoors and dry. Cutting, grinding, drilling or demolition of materials containing silica should be completed only with proper respiratory protection and other worker safety precautions that comply with applicable regulations and guidelines.

## 6.4 Mercury

Do not break lamps or separate liquid mercury from components. Recycle and reclaim mercury from fluorescent lamps and thermostats when taken out of service. Mercury is classified as a hazardous waste and must be disposed of in accordance with applicable regulations.

# 7 DISCLAIMER

The recommendations detailed in this report were carried out in a manner consistent with the level of care and skill normally exercised by reasonable members of the environmental and industrial hygiene consulting profession currently practicing under similar conditions in the area.

In preparing this report, ALL-TECH Environmental Services Limited relied on information supplied by others, including independent laboratories, and testing services. Except as expressly set out in this report, we have not made any independent verification of such information.

The recommendations in this report have been made in the context of existing industry accepted guidelines which were in place at the date of this report.

We trust this information is beneficial for assisting you in better understanding the process that has been carried out as well as the benefits and limitations of air sample results.

Should you have any questions or concerns pertaining to this report, please contact the undersigned directly.



*Larry G. Koughan, CET, CRSP*  
*Senior Project Consultant*



***APPENDIX I***

***Laboratory Certificate of Analysis – Asbestos PLM Samples***

### CERTIFICATE OF ANALYSIS

Client: ALL-TECH Environmental Services Limited  
20 Duke St., Suite 109  
Bedford NS B4A 2Z5  
  
Client: ALL131

Report Date: 12/20/2022  
Report No.: 674523 - PLM  
Project: Prince County Forestry Depot  
Project No.: PE22400

### PLM BULK SAMPLE ANALYSIS SUMMARY

**Lab No.:** 7540071  
**Client No.:** PED-01

Percent Asbestos:  
*None Detected*

**Analyst Observation:** Tan Ceiling Tile  
**Client Description:** 24"x48" Fissure Ceiling Tile  
  
Percent Non-Asbestos Fibrous Material:  
35 Cellulose  
15 Fibrous Glass

**Location:** Lower Level Corridor  
**Facility:**  
  
Percent Non-Fibrous Material:  
50

**Lab No.:** 7540072  
**Client No.:** PED-02

Percent Asbestos:  
*None Detected*

**Analyst Observation:** Tan Ceiling Tile  
**Client Description:** 24"x48" Fissure Ceiling Tile  
  
Percent Non-Asbestos Fibrous Material:  
35 Cellulose  
15 Fibrous Glass

**Location:** Lower Level Office  
**Facility:**  
  
Percent Non-Fibrous Material:  
50

**Lab No.:** 7540073  
**Client No.:** PED-03

Percent Asbestos:  
*None Detected*

**Analyst Observation:** Tan Ceiling Tile  
**Client Description:** 24"x48" Fissure Ceiling Tile  
  
Percent Non-Asbestos Fibrous Material:  
35 Cellulose  
15 Fibrous Glass

**Location:** Lower Level Office  
**Facility:**  
  
Percent Non-Fibrous Material:  
50

**Lab No.:** 7540074  
**Client No.:** PED-04

Percent Asbestos:  
*None Detected*

**Analyst Observation:** White Joint Compound  
**Client Description:** Drywall Joint Compound  
  
Percent Non-Asbestos Fibrous Material:  
None Detected

**Location:** Lower Level Boiler Room  
**Facility:**  
  
Percent Non-Fibrous Material:  
100

Note: No drywall present.

**Lab No.:** 7540075  
**Client No.:** PED-05

Percent Asbestos:  
*None Detected*

**Analyst Observation:** White Joint Compound  
**Client Description:** Drywall Joint Compound  
  
Percent Non-Asbestos Fibrous Material:  
None Detected

**Location:** Lower Level Corridor  
**Facility:**  
  
Percent Non-Fibrous Material:  
100

Note: Insufficient drywall provided for analysis.

Please refer to the Appendix of this report for further information regarding your analysis.

Date Received: 12/14/2022  
Date Analyzed: 12/20/2022  
Signature:   
Analyst: Ellen Smith

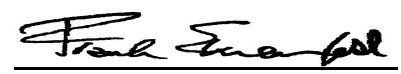
Approved By:   
Frank E. Ehrenfeld, III  
Laboratory Director

### CERTIFICATE OF ANALYSIS

Client: ALL-TECH Environmental Services Limited  
20 Duke St., Suite 109  
Bedford NS B4A 2Z5  
  
Client: ALL131

Report Date: 12/20/2022  
Report No.: 674523 - PLM  
Project: Prince County Forestry Depot  
Project No.: PE22400

### PLM BULK SAMPLE ANALYSIS SUMMARY

**Lab No.:** 7540076  
**Client No.:** PED-06

**Analyst Observation:** White Joint Compound  
**Client Description:** Drywall Joint Compound

**Location:** Lower Level Lunch Room  
**Facility:**

Percent Asbestos:  
*None Detected*

Percent Non-Asbestos Fibrous Material:  
None Detected

Percent Non-Fibrous Material:  
100

Note: No drywall present.

**Lab No.:** 7540077  
**Client No.:** PED-07

**Analyst Observation:** White Joint Compound  
**Client Description:** Drywall Joint Compound

**Location:** Main Floor Open Area  
**Facility:**

Percent Asbestos:  
*None Detected*

Percent Non-Asbestos Fibrous Material:  
None Detected

Percent Non-Fibrous Material:  
100

Note: No drywall present.

**Lab No.:** 7540078  
**Client No.:** PED-08

**Analyst Observation:** White Joint Compound  
**Client Description:** Drywall Joint Compound

**Location:** Main Floor Office  
**Facility:**

Percent Asbestos:  
*None Detected*

Percent Non-Asbestos Fibrous Material:  
None Detected

Percent Non-Fibrous Material:  
100

Note: No drywall present.

**Lab No.:** 7540079  
**Client No.:** PED-09

**Analyst Observation:** White Joint Compound  
**Client Description:** Drywall Joint Compound

**Location:** Main Floor Open Area  
**Facility:**

Percent Asbestos:  
*None Detected*

Percent Non-Asbestos Fibrous Material:  
None Detected

Percent Non-Fibrous Material:  
100

Note: No drywall present.

**Lab No.:** 7540080  
**Client No.:** PED-10

**Analyst Observation:** Tan Vinyl Sheet Flooring  
**Client Description:** Vinyl Sheet Flooring

**Location:** Main Floor Men's Washroom 105  
**Facility:**

Percent Asbestos:  
*None Detected*

Percent Non-Asbestos Fibrous Material:  
None Detected

Percent Non-Fibrous Material:  
100

Insufficient mastic to analyze

**Lab No.:** 7540081  
**Client No.:** PED-11

**Analyst Observation:** Tan Vinyl Sheet Flooring  
**Client Description:** Vinyl Sheet Flooring

**Location:** Main Floor Outside Women's  
Washroom 106

Percent Asbestos:  
*None Detected*

Percent Non-Asbestos Fibrous Material:  
None Detected

**Facility:**  
Percent Non-Fibrous Material:  
100

Please refer to the Appendix of this report for further information regarding your analysis.

Date Received: 12/14/2022

Date Analyzed: 12/20/2022

Signature:

Analyst: Ellen Smith

Approved By:

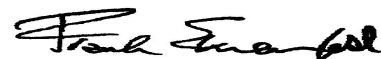

Frank E. Ehrenfeld, III  
Laboratory Director

### CERTIFICATE OF ANALYSIS

Client: ALL-TECH Environmental Services Limited  
20 Duke St., Suite 109  
Bedford NS B4A 2Z5  
  
Client: ALL131

Report Date: 12/20/2022  
Report No.: 674523 - PLM  
Project: Prince County Forestry Depot  
Project No.: PE22400

### PLM BULK SAMPLE ANALYSIS SUMMARY

|                             |   |  |
|-----------------------------|---|--|
| <b>Lab No.:</b> 7540081(L2) | <b>Analyst Observation:</b> Tan Mastic          | <b>Location:</b> Main Floor Outside Women's Washroom 106 |
| <b>Client No.:</b> PED-11   | <b>Client Description:</b> Vinyl Sheet Flooring | <b>Facility:</b>   |
| <u>Percent Asbestos:</u>    | <u>Percent Non-Asbestos Fibrous Material:</u>   | <u>Percent Non-Fibrous Material:</u>                     |
| <i>None Detected</i>        | None Detected                                   | 100  |

|                           |  |                                      |
|---------------------------|--|--------------------------------------|
| <b>Lab No.:</b> 7540082   | <b>Analyst Observation:</b> Tan Vinyl Sheet Flooring | <b>Location:</b> Main Floor Room 108 |
| <b>Client No.:</b> PED-12 | <b>Client Description:</b> Vinyl Sheet Flooring      | <b>Facility:</b>                     |
| <u>Percent Asbestos:</u>  | <u>Percent Non-Asbestos Fibrous Material:</u>        | <u>Percent Non-Fibrous Material:</u> |
| <i>None Detected</i>      | None Detected  | 100                                  |

Insufficient mastic to analyze

|                           |   |                                      |
|---------------------------|---|--------------------------------------|
| <b>Lab No.:</b> 7540083   | <b>Analyst Observation:</b> Tan Ceiling Tile            | <b>Location:</b> Main Floor Room 108 |
| <b>Client No.:</b> PED-13 | <b>Client Description:</b> 24"x48" Fissure Ceiling Tile | <b>Facility:</b>                     |
| <u>Percent Asbestos:</u>  | <u>Percent Non-Asbestos Fibrous Material:</u>           | <u>Percent Non-Fibrous Material:</u> |
| <i>None Detected</i>      | 35 Cellulose<br>17 Fibrous Glass                        | 48                                   |

|                           |   |                                      |
|---------------------------|---|--------------------------------------|
| <b>Lab No.:</b> 7540084   | <b>Analyst Observation:</b> Tan Ceiling Tile            | <b>Location:</b> Main Floor Room 108 |
| <b>Client No.:</b> PED-14 | <b>Client Description:</b> 24"x48" Fissure Ceiling Tile | <b>Facility:</b>                     |
| <u>Percent Asbestos:</u>  | <u>Percent Non-Asbestos Fibrous Material:</u>           | <u>Percent Non-Fibrous Material:</u> |
| <i>None Detected</i>      | 35 Cellulose<br>15 Fibrous Glass                        | 50                                   |

|                           |   |                                      |
|---------------------------|---|--------------------------------------|
| <b>Lab No.:</b> 7540085   | <b>Analyst Observation:</b> Tan Ceiling Tile            | <b>Location:</b> Main Floor Room 101 |
| <b>Client No.:</b> PED-15 | <b>Client Description:</b> 24"x48" Fissure Ceiling Tile | <b>Facility:</b>                     |
| <u>Percent Asbestos:</u>  | <u>Percent Non-Asbestos Fibrous Material:</u>           | <u>Percent Non-Fibrous Material:</u> |
| <i>None Detected</i>      | 35 Cellulose<br>17 Fibrous Glass                        | 48                                   |

|                           |   |                                      |
|---------------------------|---|--------------------------------------|
| <b>Lab No.:</b> 7540086   | <b>Analyst Observation:</b> White Joint Compound  | <b>Location:</b> Garage              |
| <b>Client No.:</b> PED-16 | <b>Client Description:</b> Drywall Joint Compound | <b>Facility:</b>                     |
| <u>Percent Asbestos:</u>  | <u>Percent Non-Asbestos Fibrous Material:</u>     | <u>Percent Non-Fibrous Material:</u> |
| <i>None Detected</i>      | None Detected                                     | 100                                  |

Note: No drywall present.

Please refer to the Appendix of this report for further information regarding your analysis.

Date Received: 12/14/2022  
Date Analyzed: 12/20/2022  
Signature:   
Analyst: Ellen Smith

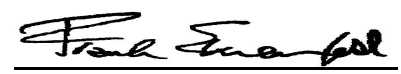
Approved By:   
Frank E. Ehrenfeld, III  
Laboratory Director

### CERTIFICATE OF ANALYSIS

Client: ALL-TECH Environmental Services Limited  
20 Duke St., Suite 109  
Bedford NS B4A 2Z5  
  
Client: ALL131

Report Date: 12/20/2022  
Report No.: 674523 - PLM  
Project: Prince County Forestry Depot  
Project No.: PE22400

### PLM BULK SAMPLE ANALYSIS SUMMARY

**Lab No.:** 7540087  
**Client No.:** PED-17

**Analyst Observation:** White Joint Compound  
**Client Description:** Drywall Joint Compound

**Location:** Garage  
**Facility:**

Percent Asbestos:  
*None Detected*

Percent Non-Asbestos Fibrous Material:  
None Detected

Percent Non-Fibrous Material:  
100

Note: No drywall present.

**Lab No.:** 7540088  
**Client No.:** PED-18

**Analyst Observation:** White Joint Compound  
**Client Description:** Drywall Joint Compound

**Location:** Garage  
**Facility:**

Percent Asbestos:  
*None Detected*

Percent Non-Asbestos Fibrous Material:  
None Detected

Percent Non-Fibrous Material:  
100

Note: No drywall present.

**Lab No.:** 7540089  
**Client No.:** PED-19

**Analyst Observation:** Tan Vinyl Sheet Flooring  
**Client Description:** Vinyl Sheet Flooring

**Location:** Garage Washroom  
**Facility:**

Percent Asbestos:  
*20 Chrysotile*

Percent Non-Asbestos Fibrous Material:  
7 Cellulose

Percent Non-Fibrous Material:  
73

Insufficient mastic to analyze

**Lab No.:** 7540090  
**Client No.:** PED-20

**Analyst Observation:** Tan Ceiling Tile  
**Client Description:** 24"x48" Fissure Ceiling Tile

**Location:** Garage Entry  
**Facility:**

Percent Asbestos:  
*None Detected*

Percent Non-Asbestos Fibrous Material:  
35 Cellulose  
20 Fibrous Glass

Percent Non-Fibrous Material:  
45

**Lab No.:** 7540091  
**Client No.:** PED-21

**Analyst Observation:** Tan Ceiling Tile  
**Client Description:** 24"x48" Fissure Ceiling Tile

**Location:** Garage Washroom  
**Facility:**

Percent Asbestos:  
*None Detected*

Percent Non-Asbestos Fibrous Material:  
35 Cellulose  
15 Fibrous Glass

Percent Non-Fibrous Material:  
50

Please refer to the Appendix of this report for further information regarding your analysis.

Date Received: 12/14/2022

Date Analyzed: 12/20/2022

Signature:

Analyst: Ellen Smith

Approved By:

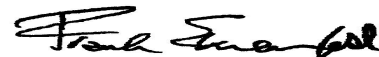

Frank E. Ehrenfeld, III  
Laboratory Director

---

CERTIFICATE OF ANALYSIS

---

Client: ALL-TECH Environmental Services Limited  
20 Duke St., Suite 109  
Bedford NS B4A 2Z5

Report Date: 12/20/2022  
Report No.: 674523 - PLM  
Project: Prince County Forestry Depot  
Project No.: PE22400

Client: ALL131

---

PLM BULK SAMPLE ANALYSIS SUMMARY

---

Lab No.: 7540092  
Client No.: PED-22

Analyst Observation: Tan Ceiling Tile  
Client Description: 24"x48" Fissure Ceiling Tile

Location: Garage Office  
Facility:

Percent Asbestos:  
*None Detected*

Percent Non-Asbestos Fibrous Material:  
35 Cellulose  
20 Fibrous Glass

Percent Non-Fibrous Material:  
45

---

Please refer to the Appendix of this report for further information regarding your analysis.

---

Date Received: 12/14/2022

Date Analyzed: 12/20/2022

Signature:

Analyst:   
Ellen Smith

Approved By:

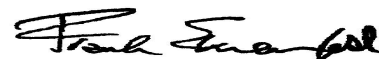

Frank E. Ehrenfeld, III  
Laboratory Director

## CERTIFICATE OF ANALYSIS

Client: ALL-TECH Environmental Services Limited  
20 Duke St., Suite 109  
Bedford NS B4A 2Z5  
  
Client: ALL131

Report Date: 12/20/2022  
Report No.: 674523 - PLM  
Project: Prince County Forestry Depot  
Project No.: PE22400

## Appendix to Analytical Report

### Customer Contact:

**Method:** 40 CFR Appendix E to Subpart E of Part 763, interim method for the Determination of Asbestos in Bulk Insulation Samples, USEPA 600, R93-116 and NYSDOH ELAP 198.1 as needed.

This appendix seeks to promote greater understanding of any observations, exceptions, special instructions, or circumstances that the laboratory needs to communicate to the client concerning the above samples. The information below is used to help promote your ability to make the most informed decisions for you and your customers. Please note the following points of contact for any questions you may have.

**iATL Customer Service:** customerservice@iatl.com

**iATL Office Manager:** wchampion@iatl.com

**iATL Account Representative:** Semih Kocahasan

**Sample Login Notes:** See Batch Sheet Attached

**Sample Matrix:** Bulk Building Materials

**Exceptions Noted:** See Following Pages

### General Terms, Warrants, Limits, Qualifiers:

General information about iATL capabilities and client/laboratory relationships and responsibilities are spelled out in iATL policies that are listed at [www.iATL.com](http://www.iATL.com) and in our Quality Assurance Manual per ISO 17025 standard requirements. The information therein is a representation of iATL definitions and policies for turnaround times, sample submittal, collection media, blank definitions, quantification issues and limit of detection, analytical methods and procedures, sub-contracting policies, results reporting options, fees, terms, and discounts, confidentiality, sample archival and disposal, and data interpretation.

iATL warrants the test results to be of a precision normal for the type and methodology employed for each sample submitted. iATL disclaims any other warrants, expressed or implied, including warranty of fitness for a particular purpose and warranty of merchantability. iATL accepts no legal responsibility for the purpose for which the client uses test results. Any analytical work performed must be governed by our Standard Terms and Conditions. Prices, methods and detection limits may be changed without notification. Please contact your Customer Service Representative for the most current information.

This confidential report relates only to those item(s) tested and does not represent an endorsement by NIST-NVLAP, AIHA LAP LLC, or any agency of local, state or province governments nor of any agency of the U.S. government.

This report shall not be reproduced except in full, without written approval of the laboratory.

### Information Pertinent to this Report:

Analysis by US EPA 600 93-116: Determination of Asbestos in Bulk Building Materials by Polarized Light Microscopy (PLM).

### Certifications:

- NIST-NVLAP No. 101165-0
- NYSDOH-ELAP No. 11021
- AIHA-LAP, LLC No. 100188

Quantification at <0.25% by volume is possible with this method. (PC) Indicates Stratified Point Count Method performed. (PC-Trace) means that asbestos was detected but is not quantifiable under the Point Counting regimen. PC Trace represents a <0.25% amount. Analysis includes all distinct separable layers in accordance with EPA 600 Method. If not reported or otherwise noted, layer is either not present or the client has specifically requested that it not be analyzed (ex. analyze until positive instructions). Small asbestos fibers may be missed by PLM due to resolution limitations of the optical microscope. Therefore, PLM is not consistently reliable in detecting asbestos in non-friable organically bound (NOB) materials. Quantitative transmission electron microscopy (TEM) is currently the only method that can pronounce materials as non-asbestos containing.

Analytical Methodology Alternatives: Your initial request for analysis may not have accounted for recent advances in regulatory requirements or advances in technology that are routinely used in similar situations for other qualified projects. You may have the option to explore additional analysis for further information. Below are a few options, listed as the matrix followed by the appropriate methodology. Also included are links to more information on our website.

Bulk Building Materials that are Non-Friable Organically Bound (NOB) by Gravimetric Reduction techniques employing PLM and TEM: ELAP 198.6 (PLM-NOB), ELAP 198.4 (TEM-NOB) See additional information at the end of this appendix.

---

CERTIFICATE OF ANALYSIS

---

Client: ALL-TECH Environmental Services Limited  
20 Duke St., Suite 109  
Bedford NS B4A 2Z5

Client: ALL131

Report Date: 12/20/2022  
Report No.: 674523 - PLM  
Project: Prince County Forestry Depot  
Project No.: PE22400

Loose Fill Vermiculite Insulation, Attic Insulation, Zonolite (copyright), etc.: US EPA 600 R-4/004 (multi-tiered analytical process)  
Sprayed On Insulation/Fireproofing with Vermiculite (SOF-V): ELAP 198.8 (PLM-SOF-V)

Soil, sludge, sediment, aggregate, and like materials analyzed for asbestos or other elongated mineral particles (ex. erionite, etc.): ASTM D7521, CARB 435, and other options available

Asbestos in Surface Dust according to one of ASTM's Methods (very dependent on sampling collection technique – by TEM): ASTM D 5755, D5756, or D6480

Various other asbestos matrices (air, water, etc.) and analytical methods are available.

**Disclaimers / Qualifiers:**

There may be some samples in this project that have a "NOTE:" associated with a sample result. We use added disclaimers or qualifiers to inform the client about something that requires further explanation. Here is a list with highlighted disclaimers that may be pertinent to this project. For a full explanation of these and other disclaimers, please inquire at **customerservice@iatl.com**.

- 1) Note: No mastic provided for analysis.
- 2) Note: Insufficient mastic provided for analysis.
- 3) Note: Insufficient material provided for analysis.
- 4) Note: Insufficient sample provided for QC reanalysis.
- 5) Note: Different material than indicated on Sample Log / Description.
- 6) Note: Sample not submitted.
- 7) Note: Attached to asbestos containing material.
- 8) Note: Received wet.
- 9) Note: Possible surface contamination.
- 10) Note: Not building material. 1% threshold may not apply.
- 11) Note: Recommend TEM-NOB analysis as per EPA recommendations.
- 12) Note: Asbestos detected but not quantifiable.
- 13) Note: Multiple identical samples submitted, only one analyzed.
- 14) Note: Analyzed by EPA 600/R-93/116. Point Counting detection limit at 0.080%.
- 15) Note: Analyzed by EPA 600/R-93/116. Point Counting detection limit at 0.125%.
- 16) Note: This sample contains >10% vermiculite mineral. See Appendix for Recommendations for Vermiculite Analysis.

**Recommendations for Vermiculite Analysis:**

Several analytical protocols exist for the analysis of asbestos in vermiculite. These analytical approaches vary depending upon the nature of the vermiculite mineral being tested (e.g. un-processed gänge, homogeneous exfoliated books of mica, or mixed mineral composites). Please contact your client representative for pricing and turnaround time options available.

iATL recommends initial testing using the EPA 600/R-93/116 method. This method is specifically designed for the analysis of asbestos in bulk building materials. It provides an acceptable starting point for primary screening of vermiculite for possible asbestos.

Results from this testing may be inconclusive. EPA suggests proceeding to a multi-tiered analysis involving wet separation techniques in conjunction with PLM and TEM gravimetric analysis (EPA 600/R-04/004).

For New York State customers, NYSDOH requires disclaimers and qualifiers for various vermiculite containing samples that direct analysis via ELAP198.6 and ELAP198.8 for samples that contain >10% vermiculite mineral where ELAP198.6 may be used to evaluate the asbestos content of the material. However, any test result using ELAP198.6 will be reported with the following disclaimer: "ELAP198.6 method does not remove vermiculite and may underestimate the level of asbestos present in a sample containing >10% vermiculite."

Further information on this method and other vermiculite and asbestos issues can be found at the following: Agency for Toxic Substances and Disease Registry (ATSDR) [www.atsdr.cdc.gov](http://www.atsdr.cdc.gov), United States Geological Survey (USGS) [www.minerals.usgs.gov/minerals/](http://www.minerals.usgs.gov/minerals/), US EPA [www.epa.gov/asbestos](http://www.epa.gov/asbestos). The USEPA also has an informative brochure "Current Best Practices for Vermiculite Attic Insulation" EPA 747F03001 May 2003, that may assist the health and remediation professional. NYS customers please follow current NYSDOH ELAP requirements per policy on subject of surfacing and vermiculite, May 6, 2016, Testing Requirements for Surfacing Material Containing Vermiculite ([https://www.wadsworth.org/sites/default/files/WebDoc/1198\\_8\\_02\\_2.pdf](https://www.wadsworth.org/sites/default/files/WebDoc/1198_8_02_2.pdf))

The following is a summary of the analytical process outlines in the EPA 600/R-04/004 Method:

- 1) **Analytical Step/Method:** Initial Screening by PLM, EPA 600R-93/116  
**Requirements/Comments:** Minimum of 0.1 g of sample. ~0.25% for most samples.

## CERTIFICATE OF ANALYSIS

Client: ALL-TECH Environmental Services Limited  
20 Duke St., Suite 109  
Bedford NS B4A 2Z5

Report Date: 12/20/2022  
Report No.: 674523 - PLM  
Project: Prince County Forestry Depot  
Project No.: PE22400

Client: ALL131

2) **Analytical Step/Method:** Wet Separation by PLM Gravimetric Technique, EPA R-04/004

**Requirements/Comments:** Minimum 50g\*\* of dry sample. Analysis of "Sinks" only.

3) **Analytical Step/Method:** Wet Separation by PLM Gravimetric Technique, EPA R-04/004

**Requirements/Comments:** Minimum 50g\*\* of dry sample. Analysis of "Floats" only.

4) **Analytical Step/Method:** Wet Separation by TEM Gravimetric Technique, EPA R-04/004

**Requirements/Comments:** Minimum 50g\*\* of dry sample. Analysis of "Sinks" only.

5) **Analytical Step/Method:** Wet Separation by TEM Gravimetric Technique, EPA R-04/004

**Requirements/Comments:** Minimum 50g\*\* of dry sample. Analysis of "Suspension" only.

\*With advance notice and confirmation by the laboratory.

\*\*Approximately 1 Liter of sample in double-bagged container (~9x6 inch bag of sample).

New York State Department of Health requires that samples originating from NYS that they categorize as Non-friable Organically Bound materials can only be confirmed as None Detected for asbestos by method 198.4. See the table below for a list of those materials. (ENVIRONMENTAL LABORATORY APPROVAL PROGRAM CERTIFICATION MANUAL - ITEM No. 198.1, Revision Date 5/6/16)

\*Asphalt Shingles, Caulking, Ceiling Tiles with Cellulose, Duct Wrap, Glazing, Mastic, Paint Chips, Resilient Floor Tiles, Rubberized Asbestos Gaskets, Siding Shingles, Vinyl Asbestos Tile, NOB materials (other than SM-V) with <10% vermiculite, Any material (Friable or NOB other than SM-V) with >10% vermiculite.

Statistically derived uncertainty with any measure should be taken into consideration when reviewing and interpreting all reported data and results. A more comprehensive listing of accuracy, precision, and uncertainty as it impacts this method is available upon request.

***APPENDIX II***

***Laboratory Certificate of Analysis – Lead Paint Samples***

### CERTIFICATE OF ANALYSIS

Client: ALL-TECH Environmental Services Limited  
20 Duke St., Suite 109  
Bedford NS B4A 2Z5  
  
Client: ALL131

Report Date: 12/21/2022  
Report No.: 674511 - Lead Paint  
Project: Prince County Forestry Depot  
Project No.: PE22400

### LEAD PAINT SAMPLE ANALYSIS SUMMARY

|                            |                                      |                                      |
|----------------------------|--------------------------------------|--------------------------------------|
| <b>Lab No.:</b> 7539861    | <b>Description:</b> Brown Trim Paint | <b>Result (% by Weight):</b> <0.0072 |
| <b>Client No.:</b> PFDP-01 | <b>Location:</b> Lower Level         | <b>Result (ppm):</b> <72             |
|                            |                                      | <b>Comments:</b> ***                 |

|                            |                                      |                                      |
|----------------------------|--------------------------------------|--------------------------------------|
| <b>Lab No.:</b> 7539862    | <b>Description:</b> Beige Door Paint | <b>Result (% by Weight):</b> <0.0056 |
| <b>Client No.:</b> PFDP-02 | <b>Location:</b> Lower Level         | <b>Result (ppm):</b> <56             |
|                            |                                      | <b>Comments:</b> ***                 |

|                            |                                     |                                    |
|----------------------------|-------------------------------------|------------------------------------|
| <b>Lab No.:</b> 7539863    | <b>Description:</b> Green Paint     | <b>Result (% by Weight):</b> 0.021 |
| <b>Client No.:</b> PFDP-03 | <b>Location:</b> Lower Level Office | <b>Result (ppm):</b> 210           |
|                            |                                     | <b>Comments:</b> ***               |

|                            |                                      |                                      |
|----------------------------|--------------------------------------|--------------------------------------|
| <b>Lab No.:</b> 7539864    | <b>Description:</b> Grey Floor Paint | <b>Result (% by Weight):</b> <0.0069 |
| <b>Client No.:</b> PFDP-04 | <b>Location:</b> Boiler Rm           | <b>Result (ppm):</b> <69             |
|                            |                                      | <b>Comments:</b>                     |

|                            |                                      |                                     |
|----------------------------|--------------------------------------|-------------------------------------|
| <b>Lab No.:</b> 7539865    | <b>Description:</b> Beige Trim Paint | <b>Result (% by Weight):</b> <0.017 |
| <b>Client No.:</b> PFDP-05 | <b>Location:</b> Main Floor 108      | <b>Result (ppm):</b> <170           |
|                            |                                      | <b>Comments:</b> *                  |

|                            |                                |                                      |
|----------------------------|--------------------------------|--------------------------------------|
| <b>Lab No.:</b> 7539866    | <b>Description:</b> Grey Paint | <b>Result (% by Weight):</b> <0.0087 |
| <b>Client No.:</b> PFDP-06 | <b>Location:</b> Exterior      | <b>Result (ppm):</b> <87             |
|                            |                                | <b>Comments:</b>                     |

|                            |                                      |                                    |
|----------------------------|--------------------------------------|------------------------------------|
| <b>Lab No.:</b> 7539867    | <b>Description:</b> White Trim Paint | <b>Result (% by Weight):</b> 0.035 |
| <b>Client No.:</b> PFDP-07 | <b>Location:</b> Exterior            | <b>Result (ppm):</b> 350           |
|                            |                                      | <b>Comments:</b>                   |

|                            |                                      |                                      |
|----------------------------|--------------------------------------|--------------------------------------|
| <b>Lab No.:</b> 7539868    | <b>Description:</b> Grey Floor Paint | <b>Result (% by Weight):</b> <0.0075 |
| <b>Client No.:</b> PFDP-08 | <b>Location:</b> Garage              | <b>Result (ppm):</b> <75             |
|                            |                                      | <b>Comments:</b>                     |

Please refer to the Appendix of this report for further information regarding your analysis.

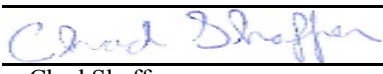
Date Received: 12/14/2022  
Date Analyzed: 12/21/2022  
Signature:   
Analyst: Chad Shaffer

Approved By:   
Frank E. Ehrenfeld, III  
Laboratory Director

---

CERTIFICATE OF ANALYSIS

---

Client: ALL-TECH Environmental Services Limited  
20 Duke St., Suite 109  
Bedford NS B4A 2Z5

Report Date: 12/21/2022  
Report No.: 674511 - Lead Paint  
Project: Prince County Forestry Depot  
Project No.: PE22400

Client: ALL131

---

LEAD PAINT SAMPLE ANALYSIS SUMMARY

---

Lab No.: 7539869  
Client No.: PFDP-09

Description: Beige Wall Paint  
Location: Garage

Result (% by Weight): <0.0068  
Result (ppm): <68  
Comments:

Lab No.: 7539870  
Client No.: PFDP-10

Description: Grey Cabinet Paint  
Location: Garage

Result (% by Weight): <0.0068  
Result (ppm): <68  
Comments:

---

Please refer to the Appendix of this report for further information regarding your analysis.

---

Date Received: 12/14/2022

Date Analyzed: 12/21/2022

Signature:

Analyst: Chad Shaffer

Approved By:

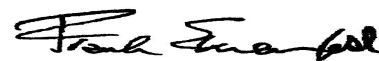

Frank E. Ehrenfeld, III

Laboratory Director

## CERTIFICATE OF ANALYSIS

Client: ALL-TECH Environmental Services Limited  
20 Duke St., Suite 109  
Bedford NS B4A 2Z5  
  
Client: ALL131

Report Date: 12/21/2022  
Report No.: 674511 - Lead Paint  
Project: Prince County Forestry Depot  
Project No.: PE22400

## Appendix to Analytical Report:

### Customer Contact:

Method: ASTM D3335-85a, US EPA SW846 3050B:7000B

This appendix seeks to promote greater understanding of any observations, exceptions, special instructions, or circumstances that the laboratory needs to communicate to the client concerning the above samples. The information below is used to help promote your ability to make the most informed decisions for you and your customers. Please note the following points of contact for any questions you may have.

**iATL Customer Service:** customerservice@iatl.com

**iATL Office Manager:** wchampion@iatl.com

**iATL Account Representative:** Semih Kocahasan

**Sample Login Notes:** See Batch Sheet Attached

**Sample Matrix:** Paint

**Exceptions Noted:** See Following Pages

### General Terms, Warrants, Limits, Qualifiers:

General information about iATL capabilities and client/laboratory relationships and responsibilities are spelled out in iATL policies that are listed at [www.iATL.com](http://www.iATL.com) and in our Quality Assurance Manual per ISO 17025 standard requirements. The information therein is a representation of iATL definitions and policies for turnaround times, sample submittal, collection media, blank definitions, quantification issues and limit of detection, analytical methods and procedures, sub-contracting policies, results reporting options, fees, terms, and discounts, confidentiality, sample archival and disposal, and data interpretation.

iATL warrants the test results to be of a precision normal for the type and methodology employed for each sample submitted. iATL disclaims any other warrants, expressed or implied, including warranty of fitness for a particular purpose and warranty of merchantability. iATL accepts no legal responsibility for the purpose for which the client uses test results. Any analytical work performed must be governed by our Standard Terms and Conditions. Prices, methods and detection limits may be changed without notification. Please contact your Customer Service Representative for the most current information.

This confidential report relates only to those item(s) tested and does not represent an endorsement by NIST-NVLAP, AIHA LAP LLC, or any agency of local, state or province governments nor of any agency of the U.S. government.

This report shall not be reproduced except in full, without written approval of the laboratory.

### Information Pertinent to this Report:

Analysis by ASTM D3335-85a by AAS

#### Certification:

- National Lead Laboratory Program (NLLAP): AIHA-LAP, LLC No. 100188

- NYSDOH-ELAP No. 11021

This report meets the standards set forth in the EPA's National Lead Laboratory Accreditation Program (NLLAP) through the Laboratory Quality System Requirements (LQSR) Revision 3.0 November 5, 2007. All Environmental Lead Proficiency Analytical Testing (ELPAT) is through the AIHA-PAT established program.

Regulatory limit is 0.5% lead by weight (EPA/HUD guidelines). Recommend multiple sampling for all samples less than regulatory limit for confirmation. All results are based on the samples as received at the lab. iATL assumes that appropriate sampling methods have been used and that the data upon which these results are based have been accurately supplied by the client.

Method Detection Limit (MDL) per EPA Method 40CFR Part 136 Appendix B.

Reporting Limit (RL) based upon Lowest Standard Determined (LSD) in accordance with AIHA-ELLAP policies.

LSD=0.2 ppm MDL=0.006% by weight. RL=0.010% by weight (based upon 100 mg sampled).

### Disclaimers / Qualifiers:

There may be some samples in this project that have a "NOTE:" associated with a sample result. We use added disclaimers or qualifiers to inform the client about something that requires further explanation. Here is a complete list with highlighted disclaimers pertinent to this project. For a full explanation of these and other disclaimers, please inquire at [customerservice@iatl.com](mailto:customerservice@iatl.com).

---

CERTIFICATE OF ANALYSIS

---

Client: ALL-TECH Environmental Services Limited  
20 Duke St., Suite 109  
Bedford NS B4A 2Z5

Report Date: 12/21/2022  
Report No.: 674511 - Lead Paint  
Project: Prince County Forestry Depot  
Project No.: PE22400

Client: ALL131

\* Insufficient sample provided to perform QC reanalysis (<200 mg)  
\*\* Not enough sample provided to analyze (<50 mg)  
\*\*\* Matrix / substrate interference possible.

< less than sign, signifies none-detected below the empirical value based upon sub-sampled mass. This is often below the Reporting Limit (see above).

## ***APPENDIX III***

### ***Site Drawings with sample locations***

ASBESTOS SURVEY BY

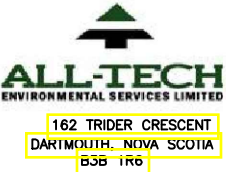

ASBESTOS LEGEND

- = CEILING
- = FLOOR
- = CEILING AND FLOOR
- = UNSURVEYED AREA
- = APPLIANCE
- = MECHANICAL
- = PIPE MATERIAL
- = DUCT WORK
- = THERMOSTAT
- = ACM WALL
- = LEAD PAINT WALL
- = SAMPLE NUMBER  
ASBESTOS DETECTED
- = SAMPLE NUMBER  
NOT ASBESTOS DETECTED
- = SAMPLE NUMBER  
LEAD DETECTED
- = SAMPLE NUMBER  
NOT LEAD DETECTED

PE22400  
PRINCE COUNTY  
FORESTRY DEPOT  
40 HACKMATAK RD  
WELLINGTON, PEI

Drawing

PRINCE COUNTY  
FORESTRY DEPOT  
BASEMENT FLOOR

Design: LK  
Date: FEB\_2023  
Drawn: AJH  
Date: MAR\_2023

NOTE:  
THIS DRAWING SHOULD BE USED  
FOR REFERENCE PURPOSES ONLY  
REFER TO THE ASBESTOS AND  
LEAD SURVEYS FOR THE ROOM BY  
ROOM DATE FOR SPECIFIC DETAILS

Scale 1 OF 2  
Scale NOT TO SCALE  
Revisions Date

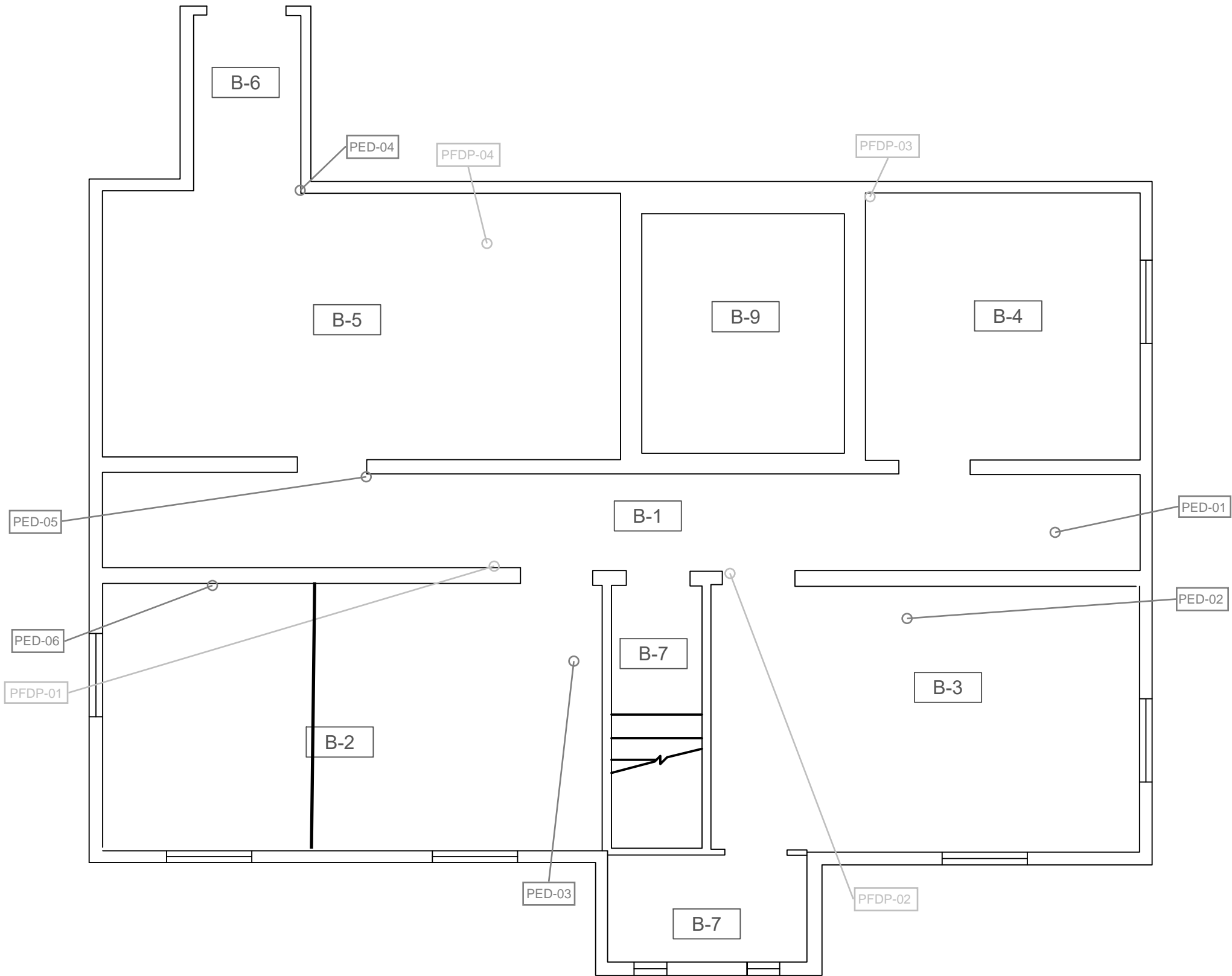

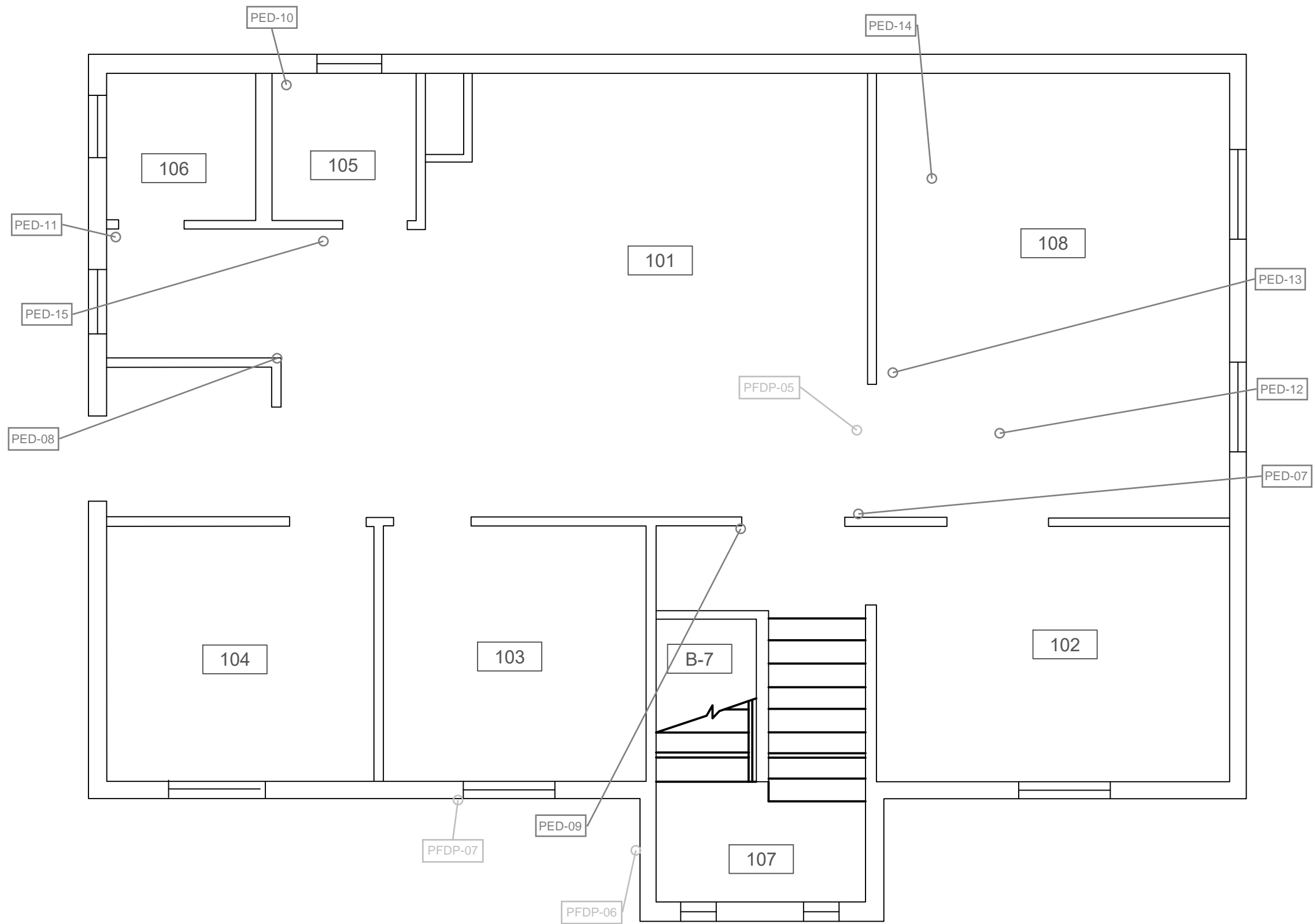

ASBESTOS SURVEY BY

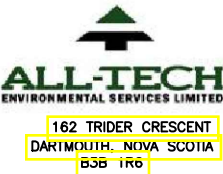

ASBESTOS LEGEND

- = CEILING
- = FLOOR
- = CEILING AND FLOOR
- = UNSURVEYED AREA
- = APPLIANCE
- = MECHANICAL
- = PIPE MATERIAL
- = DUCT WORK
- = ELECTRICAL
- = THERMOSTAT
- = ACM WALL
- = LEAD PAINT WALL
- = SAMPLE NUMBER ASBESTOS DETECTED
- = SAMPLE NUMBER NOT ASBESTOS DETECTED
- = SAMPLE NUMBER LEAD DETECTED
- = SAMPLE NUMBER NOT LEAD DETECTED

PE22400  
PRINCE COUNTY  
FORESTRY DEPOT  
40 HACKMATAK RD  
WELLINGTON, PEI

|         |          |         |
|---------|----------|---------|
| Drawing |          | dessin  |
| Design  | UK       | conçu   |
| Date    | FEB_2023 |         |
| Drawn   | AJH      | dessiné |
| Date    | MAR_2023 |         |

NOTE:  
THIS DRAWING SHOULD BE USED  
FOR REFERENCE PURPOSES ONLY  
REFER TO THE ASBESTOS AND  
LEAD SURVEYS FOR THE ROOM BY  
ROOM DATE FOR SPECIFIC DETAILS

|           |              |
|-----------|--------------|
| Scale     | 2 OF 2       |
| Scale     | NOT TO SCALE |
| Revisions |              |
|           | Date         |

## ***APPENDIX IV***

### ***Summary of ACM conditions report***

# Prince County Forestry Depot - Summary of ACM Conditions Report (2022)

| Room No. | Description     | Sample No. | Material description               | Asbestos Type & Content (%) | Estimated area | Friable (F) Non-friable (NF) | Access | Condition | Action Code (refer to legend) | Photo   |
|----------|-----------------|------------|------------------------------------|-----------------------------|----------------|------------------------------|--------|-----------|-------------------------------|---|
| NA       | Garage washroom | PED-19     | Brown and tan vinyl sheet flooring | Chrysotile 20%              | 4 m2           | F                            | A      | good      | 5                             |  |

## LEGEND

### Sample Number Identifiers

|         |  |
|---------|--|
| PED-##  | actual sample number                           |
| VPED-## | visually identified same as this sample number |

### Units

|      |                                       |
|------|---------------------------------------|
| EA   | Each                                  |
| m    | meters                                |
| m2   | square metres                         |
| m3   | cubic metres                          |
| PACM | presumed asbestos containing material |

## ASSESSMENT CODES

| ACCESS |   | CONDITION |   |
|--------|---|-----------|---|
| A      | Accessible to all building occupants  | GOOD      | ACM is completely covered and/or exhibits no evidence of damage or deterioration      |
| B      | Accessible to maintenance and operations staff without a ladder                                 | FAIR      | Minor penetrating damage to ACM (cuts, tears, nicks, deterioration, or delamination). |
| C      | Accessible to maintenance and operations staff with a ladder. Also rarely entered, locked areas | POOR      | ACM is damaged, deteriorated or delaminated   |
| D      | Not normally accessible   |           |   |

## ACTION CODES

|   |  |   |  |
|---|--|---|--|
| 1 | Immediate Clean-up of Debris that is likely to be disturbed. | 4 | ACM repair                             |
| 2 | ACM Removal required for compliance.                         | 5 | Continued management and surveillance. |
| 3 | Proactive ACM Removal.                                       |   |  |

## ***APPENDIX V***

### ***Summary of other Hazardous Materials report***

# Prince County Forestry Depot - Summary of other Hazardous Materials Report (2022)

## Lead Paint

| Room No. | Location | Sample No. | Paint colour / substrate | Lead Content (%) | Estimated Area (m2) | Comments | Photo |
|----------|----------|------------|--------------------------|------------------|---------------------|----------|-------|
|----------|----------|------------|--------------------------|------------------|---------------------|----------|-------|

## Silica

| Room No. | Location              | Sample No. | Material   | Comments | Photo |
|----------|-----------------------|------------|--|----------|-------|
| NA       | Exterior;<br>basement | NA         | Concrete walls and floor in basement and garage footing. |          |       |

## Mercury

| Material                   | Comments  | Photo  |
|----------------------------|---|--|
| Mercury filled thermostats | all like thermostats considered mercury filled. |  |